



Rossendale  
& Hyndburn

# **A human rights based response to the impacts of welfare conditionality**

Jo Chimes, Sian Jordan and Dee Lynch



## **The Welfare Reform and Preventative Casework Project**



## **The Equality and Welfare Reform Transformation Project**

# A rights based response

show **Respect** for people's dignity and rights

**Involve** people with direct experience of issues

**Give** confidence and empower people

use **Human rights** in everyday situations

build **Trust** and understanding

build and support **Sustainable** services and progress

citizens  
advice

Rossendale  
& Hyndburn



# Conditionality



imposes **Control** and requires compliance  
it's a panopticon of **Oversight**

builds a **Narrative of shame**

has a **Disproportionate impact** on disabled people  
the so called **Incentives are disincentives**

uses **Threat** of sanctions as punishment

lack of **Income** leads to multiple cluster problems

**Online** journal is a means of control

**Negative** enforcement, not positive rights

**Antithesis of positive behaviour change**

they say it is **Like work** but it is without the protections that workers get

it is **Ineffective** at helping people get in, stay in & get on at work

it **Triggers** and escalates a spiral of negative outcomes

emphasis on do-it-**Yourself** work searching and support

# Conditionality

citizens  
advice

Rossendale  
& Hyndburn

*A General Idea of a PENITENTIARY PANOPTICON in an Improved, but as yet (Jan 1792) Unfinished State.  
See Postscript References to Plan, Elevation, & Section (being Plate referred to as N<sup>o</sup> 2).*

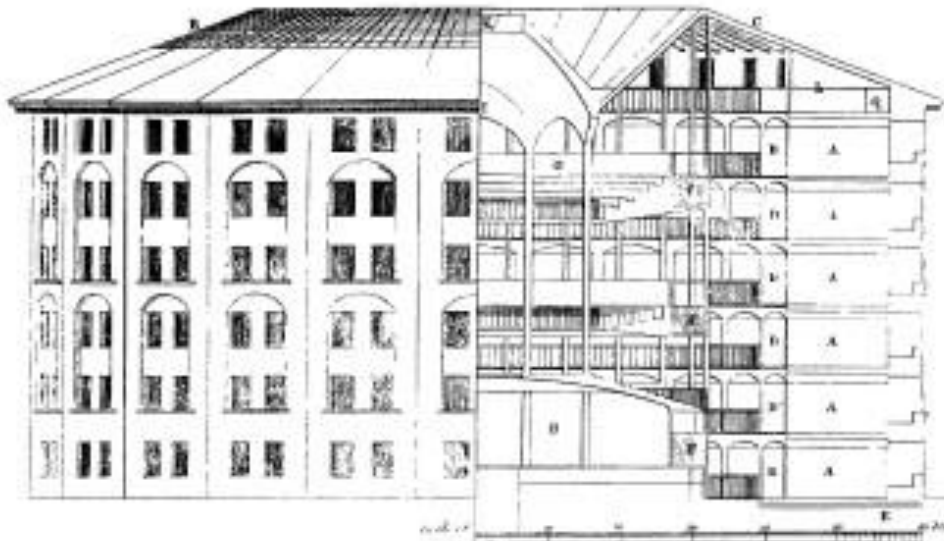

## EXPLANATION.

- L. Cells
- Next row towards the Light
- B. Cell Galleries
- E. Aisles
- F. Inspection Galleries
- G. Chapel Galleries
- H. Inspection Lodge
- I. Door of the Chapel
- K. The South Wall
- L. The Windows with their shutters, so made that within the cells will all stand close, & so as not to be seen by the Inspectors
- M. Floor of the Chapel
- N. Circular opening in the floor next to the Chapel door to light the Inspectors's Lodge
- O. Another Wall from top to bottom, for light, air, and observation.

From a 1792 Engraving

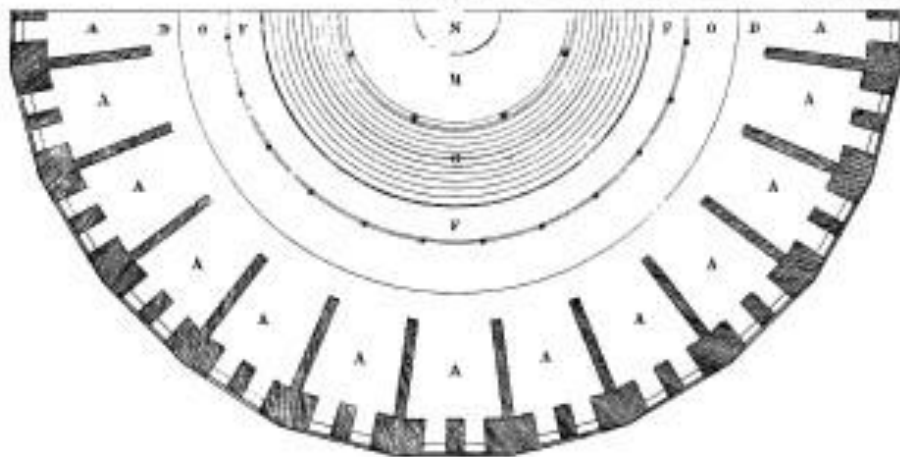



Rossendale  
& Hyndburn

show  
**Respect** for  
people's  
dignity and  
rights





citizens  
advice

Rossendale  
& Hyndburn



NOTHING

ABOUT US

WITHOUT US

**Involve**  
people with  
direct  
experience  
of issues



Rossendale  
& Hyndburn

**Give  
confidence**  
and  
empower  
people





use

**Human  
rights**

in everyday  
situations

build **Trust** and understanding

citizens  
advice

Rossendale  
& Hyndburn





build and support  
**Sustainable** services and  
progress

citizens  
advice

Rossendale  
& Hyndburn



# Thank you!

Jo Chimes, Sian Jordan and Dee Lynch

Citizens Advice Rossendale & Hyndburn

[projectlead@rossendalecab.cabnet.org.uk](mailto:projectlead@rossendalecab.cabnet.org.uk)

@equalityCARH